



SOLUTIONS FOR THE BUILT WORLD

Lake Forest Library



www.wje.com

WJE | ENGINEERS
ARCHITECTS
MATERIALS SCIENTISTS

Wiss, Janney, Elstner Associates, Inc.

February 15, 2022



Wiss, Janney, Elstner Associates, Inc.

Wiss, Janney, Elstner Associates, Inc.

Founded in 1956, Wiss, Janney, Elstner Associates, Inc., is a global firm of engineers, architects, and materials scientists committed to helping clients solve, repair, and avoid problems in the built world.

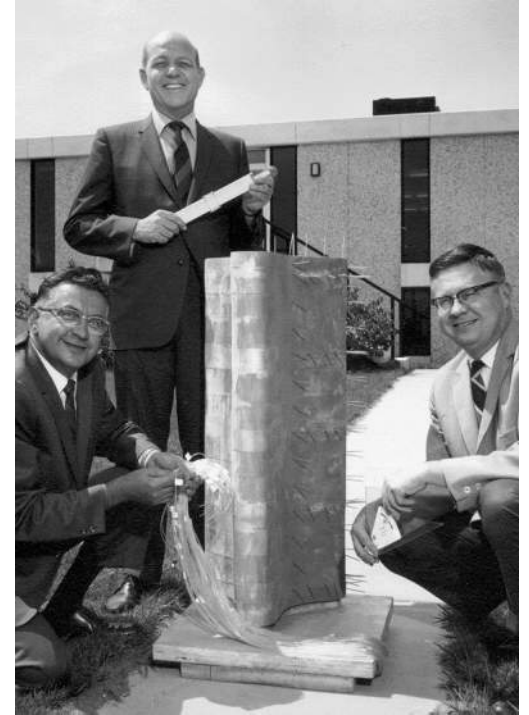

Disciplines

- Architecture
- Historic Preservation
- Structural Engineering and Testing
- Materials Science
- Geotechnical Engineering
- Fire Protection Engineering and Life Safety
- Metallurgical Engineering
- Other Disciplines

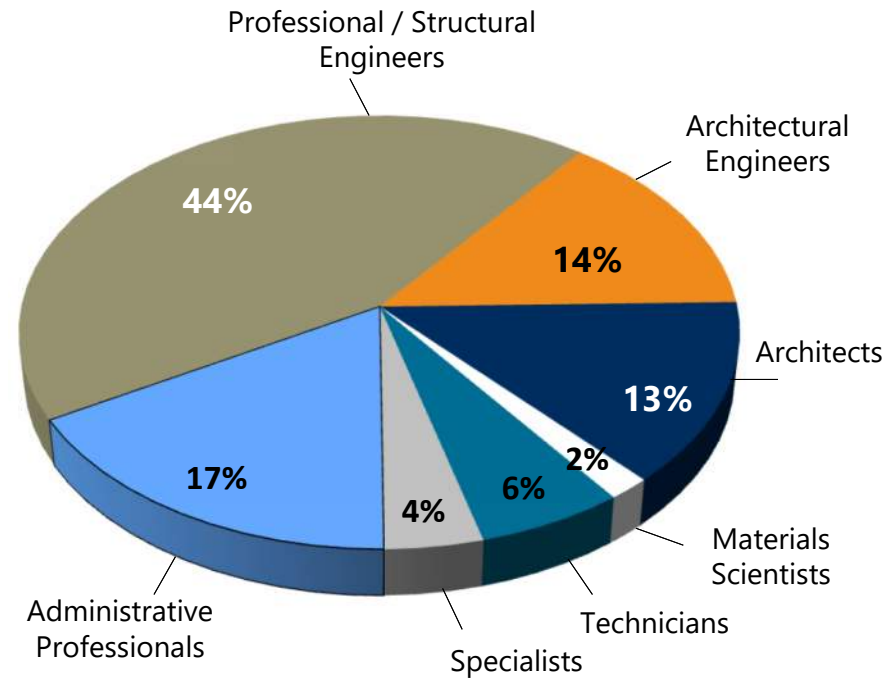

Services

- Historic Preservation
- Building Enclosure
- Building Science

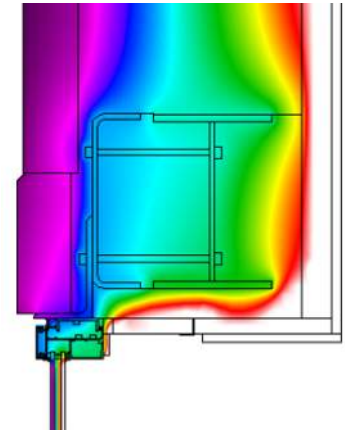

Lake Forest Library Dome



Original construction 1930–1931



Photo by R O G Studio

The New Reed Memorial Library

View of the new Kersey Coates Reed Memorial library which is nearing completion on Deerpath, East, just east of the Methodist Episcopal church. The handsome building with its splendid equipment and rich furnishings is a gift to the city by Mrs. Reed and her sister, Mrs. Charles H. Schweppe. Its estimated cost is \$250,000.

Architect:
Edwin H. Clark

General Contractor:
H. F. Friestedt Co.

Sheet metal roofing:
John W. Thompson Co.

March 1931

Changes over time

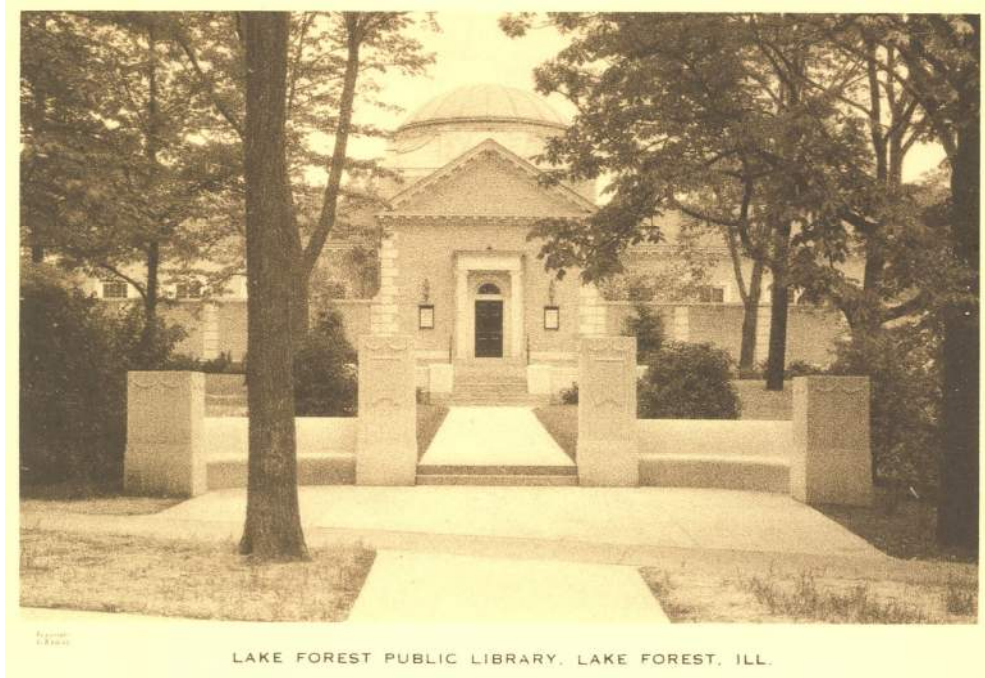

1930s



1950s–1960s

Gutter added

Changes over time



1984 Dome Replacement



Changes over time



Dome Assembly

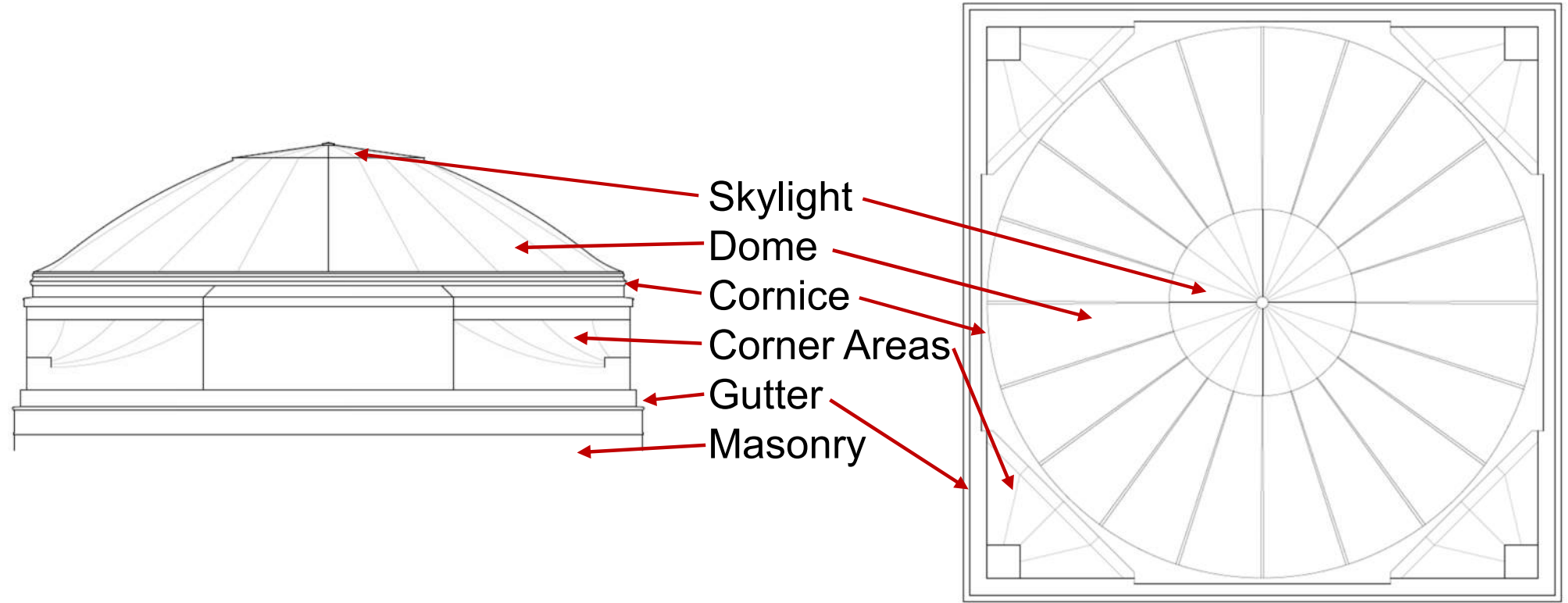

Skylight

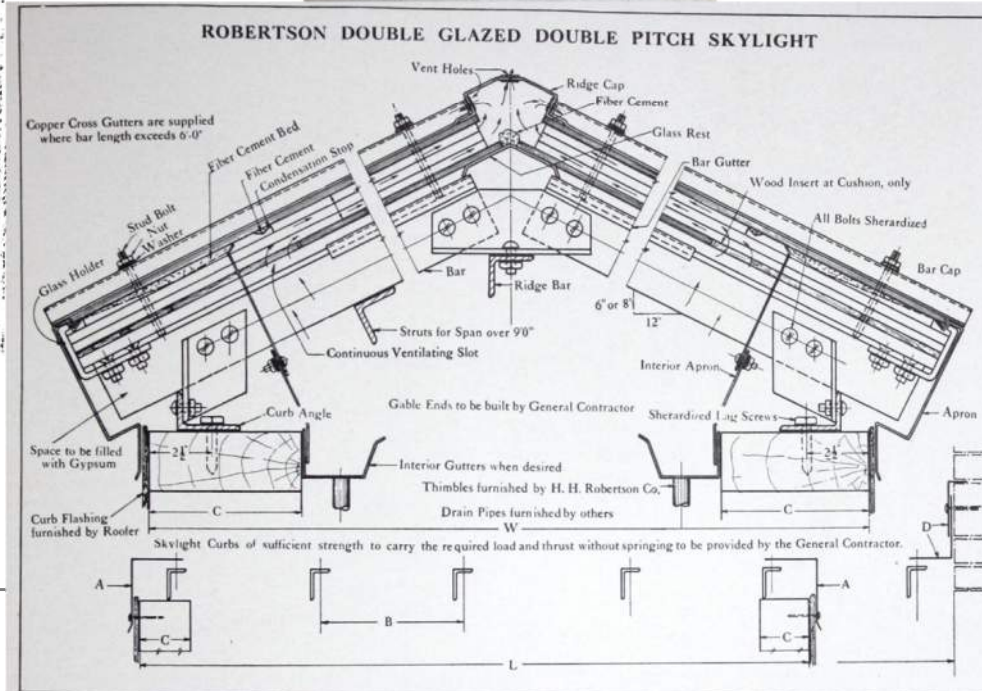
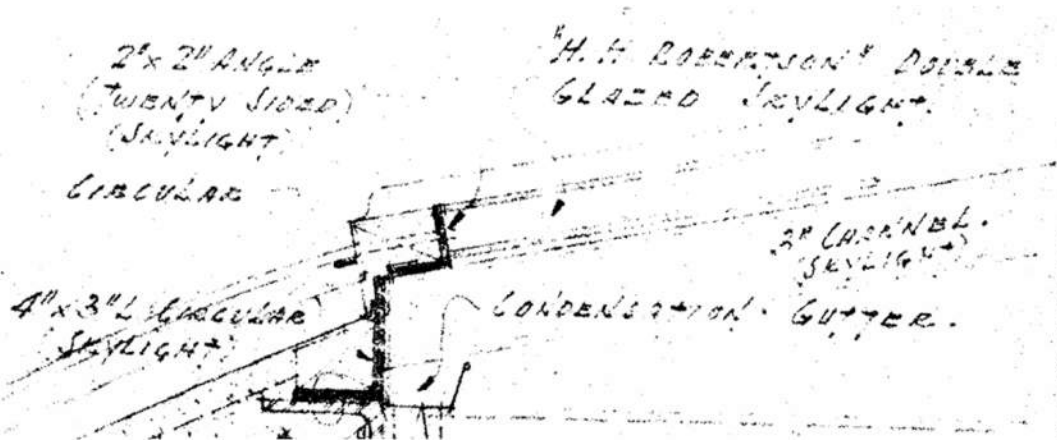
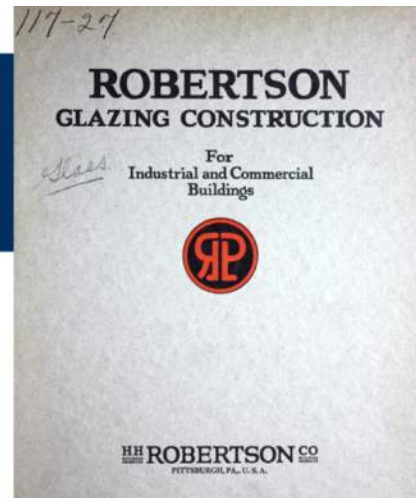

Skylight



Dome

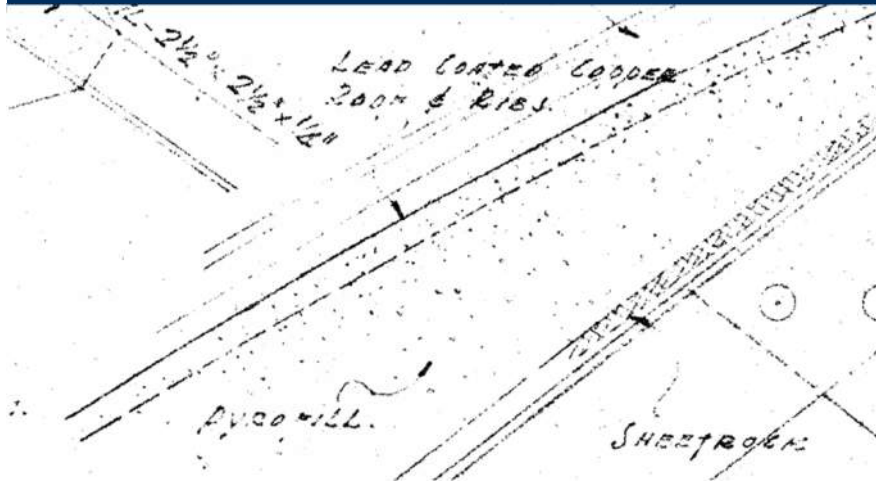

The Red Book

of Building Material

Contracting Division
Fireproofing Specialties
Roof and Floor Constructions



United States Gypsum Company
300 West Adams Street, Chicago

United States Gypsum Company

SHEETROCK-PYROFILL ROOF CONSTRUCTION

General—Sheetrock-Pyrofill System of Roof construction consists of permanent Sheetrock forms and Pyrofill (Gypsum Fiber Concrete) reinforced with an electrically-welded, galvanized steel fabric supported on subpurlins clipped to the main structural steel purlins. It is sold only completely erected by the Contracting Division of the United States Gypsum Company.



Dome



Cornice

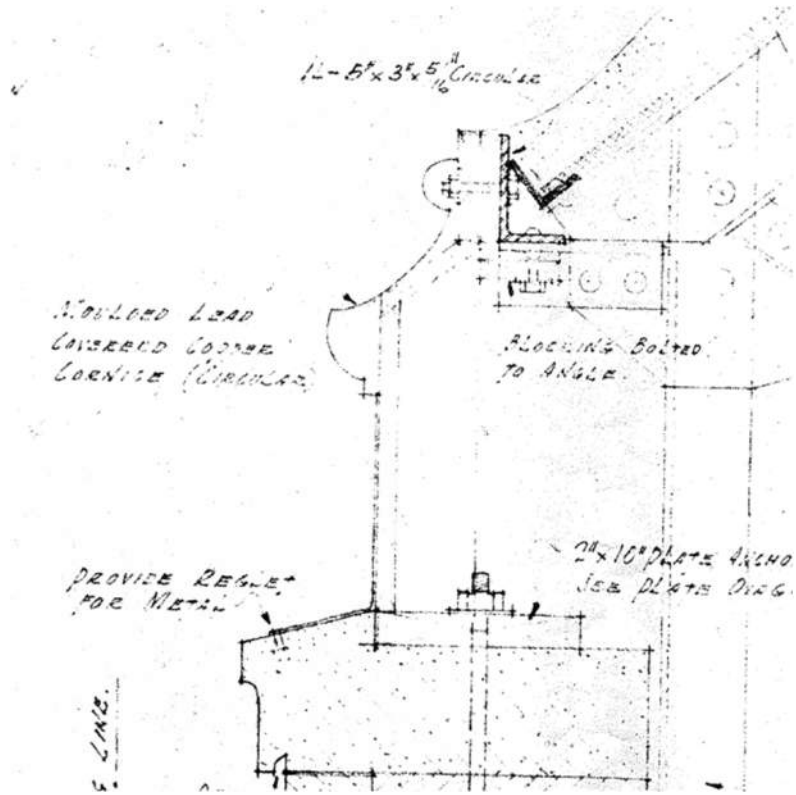

Cornice



1984



Corner Areas

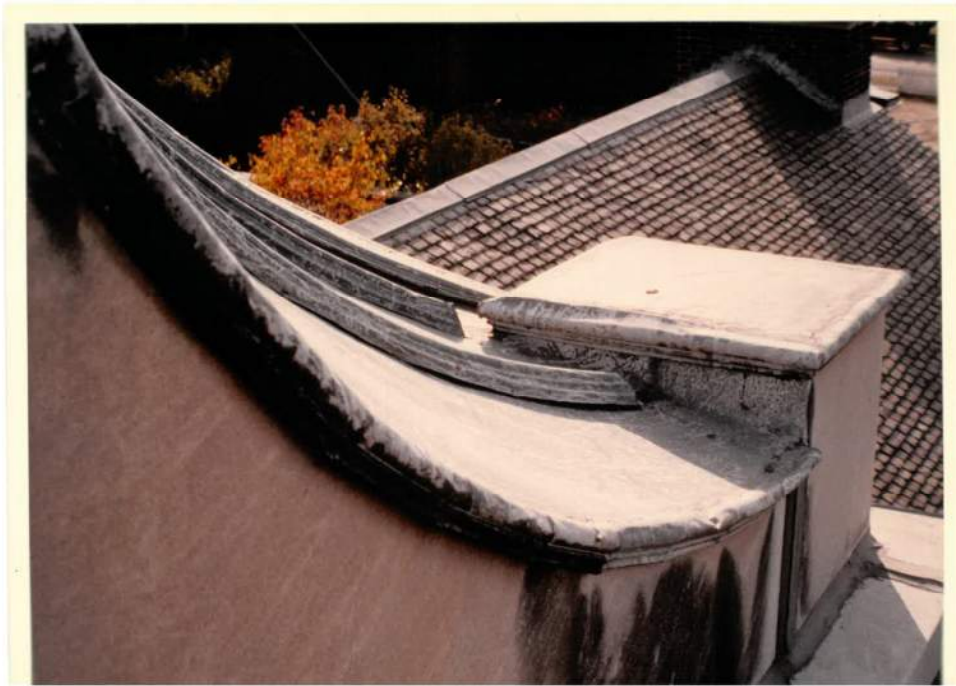

1984



Masonry



Drainage

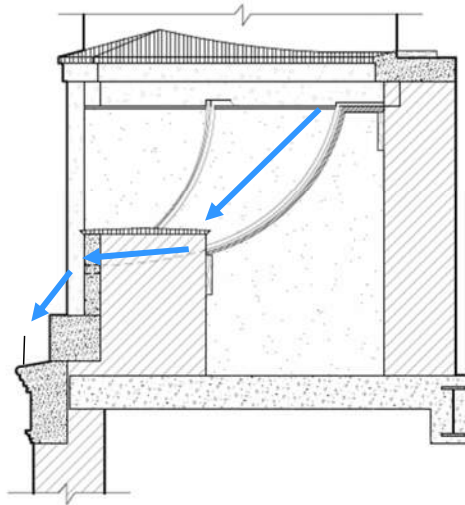
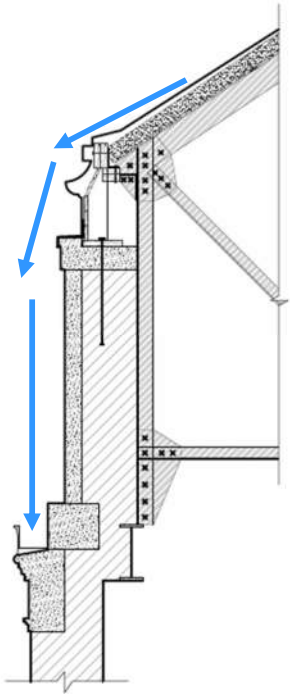

Laylight

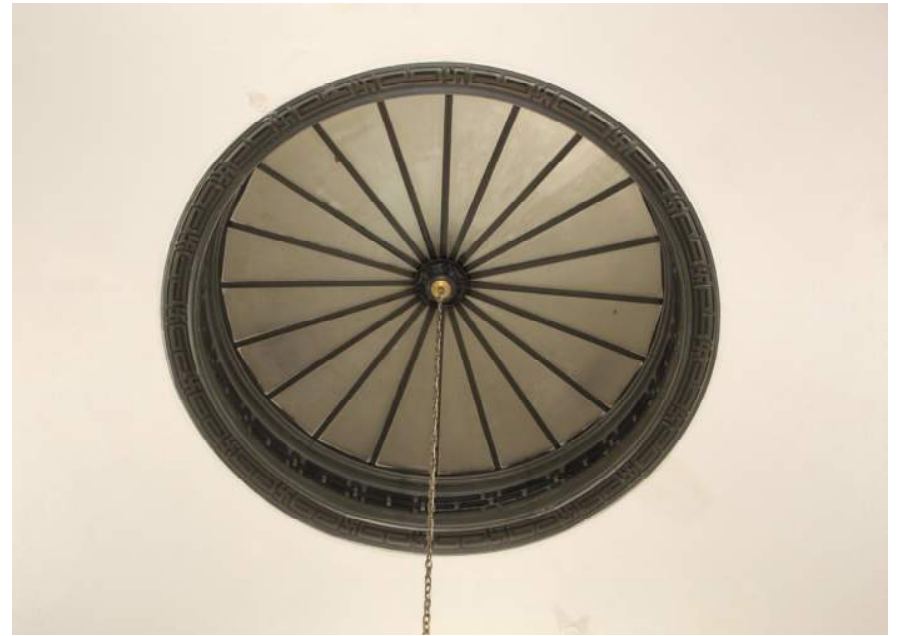

Circulation Room Ceiling



Murals



Next Steps

- Develop Schematic Concepts (in progress)
- Review by Library Board (March)
- Schematic Design and Pricing (April)
- Confirm scope and proceed to Construction Documents